

# Headwaters Siding Collection

## Half Log – Log on Log - SH007

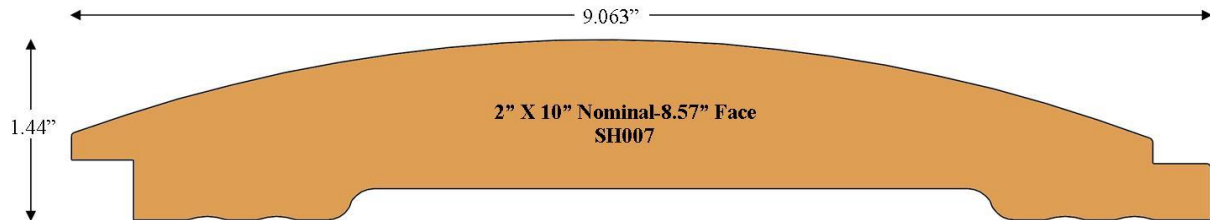

### Available Specifications

Species -	Alaskan Pine*, White Pine, Cedar*, Redwood*
Finish -	Prefinish Available - Sikkens Wood Finish Specialist
Colors -	<u>Log &amp; Siding</u> , <u>SRD</u> , <u>Semi-Transparent</u> , <u>Rubbol Solid</u> , Custom colors also available
Edge detail -	Shi lap – Face Nailed
Surface -	Sanded Face
Thickness -	2" Nominal
Widths -	10" Nominal ( <a href="#">Click for pattern details</a> )
Grades (specie dependent) -	Tight Knot, Select, Clear Vertical Grain
	* Non-resinous - no pitch bleed

### Installation Guide

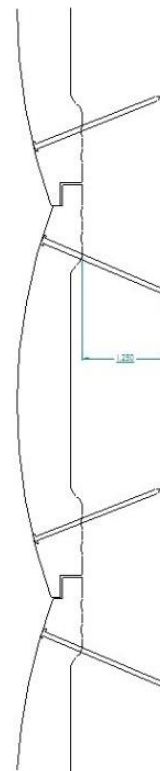

Recommended  $\frac{1}{4}$ " penetration of stainless steel siding screw or nail into wood substrate (sheeting and wall studs) behind siding. Horizontal installation, nail into each wall stud. Use  $2\frac{1}{4}$ " trim screw or  $2\frac{1}{2}$ " stainless steel nail provided there is no foam board behind siding.

[Click to enlarge](#)

[www.kwaterskibros.com](http://www.kwaterskibros.com)

*Nation's Largest Selection of Creative Wood Products*