

Heritage Siding Collection

Channel – SM004

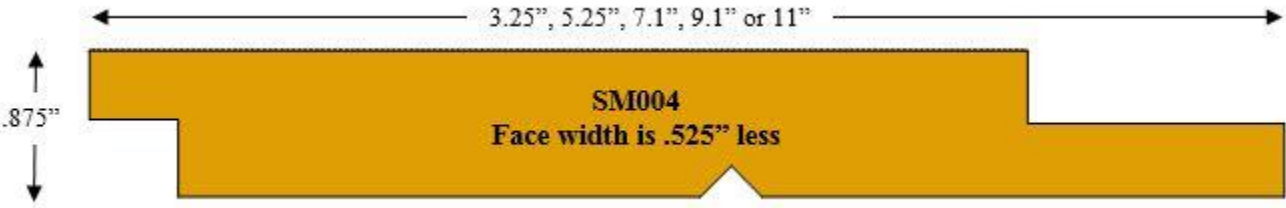

Available Specifications

- Species - White Pine, Cedar*, Redwood*, Ipe*
 - Colors - Log & Siding , SRD , Semi-Transparent , Rubbol Solid , Custom colors also available
 - Edge detail - Shiplap – Face Nailed
 - Surface - Wirebrushed Rough or Sanded Face
 - Thickness - 1" Nominal
 - Widths - 4" , 6" , 8" , 10" , 12" Nominal ([Click for pattern details](#))
 - Grades (specie dependent) - Tight Knot, Select, Clear Vertical Grain
- * Non-resinous - no pitch bleed

Installation Guide

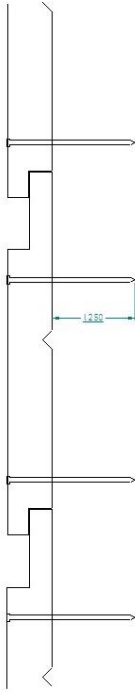

Recommended $1\frac{1}{4}$ " penetration of stainless steel siding screw or nail into wood substrate (sheeting and wall studs) behind siding. Horizontal and diagonal installation, fasten into each wall stud. Vertical installation requires additional blocking every 24" between wall studs. Use $2\frac{1}{4}$ " trim screw or $2\frac{1}{2}$ " stainless steel nail provided there is no foam board behind siding.

[Click to enlarge](#)

www.kwaterskibros.com

Nation's largest selection of creative wood products