

Hewn Log Siding Collection

4" Hewn Log – SE004

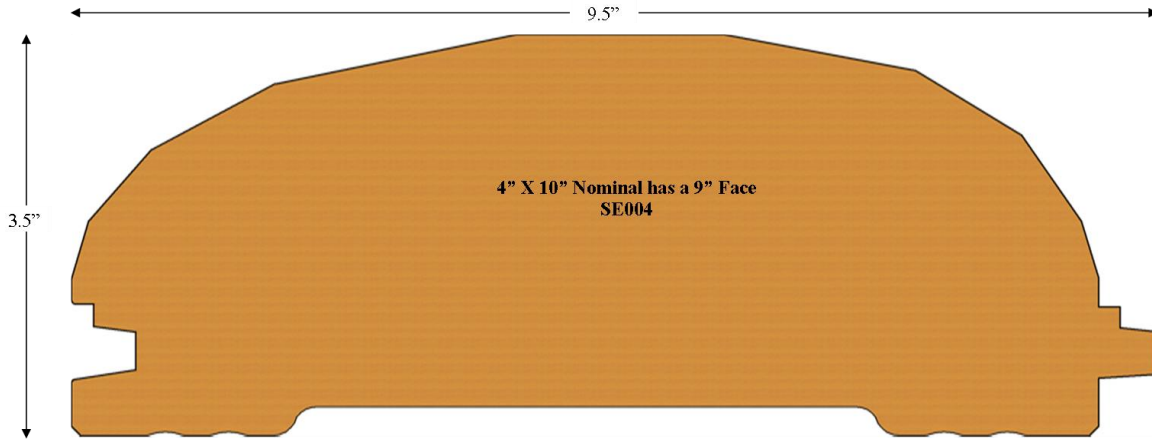

Available Specifications

Species -	White Pine, Cedar*, Redwood*
Colors -	<u>Log & Siding</u> , <u>SRD</u> , <u>Semi-Transparent</u> , <u>Rubbol Solid</u> , Custom colors also available
Edge detail -	Double Step Tongue and Groove – Hidden Fastener
Surface -	Hewn and Sanded Face
Thickness -	4" Nominal
Widths -	10" Nominal (Click for pattern details)
Grades (specie dependent) -	Tight Knot, Select, Clear Vertical Grain * Non-resinous - no pitch bleed

Installation Guide

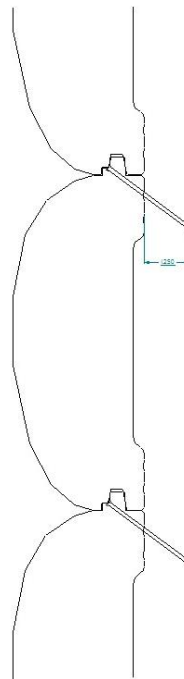

Recommended $1\frac{1}{4}$ " penetration of stainless steel siding screw into wood substrate (sheeting and wall studs) behind siding. Horizontal and diagonal installation, nail into each wall stud. Vertical installation requires additional blocking every 24" between wall studs. Use 3" trim screw provided there is no installation requires additional blocking between studs every 32".

[Click to enlarge](#)

www.kwaterskibros.com

Nation's Largest Selection of Creative Wood Products