

Hewn Log Siding Collection

4x12 Shiplap Hewn Log – SE012

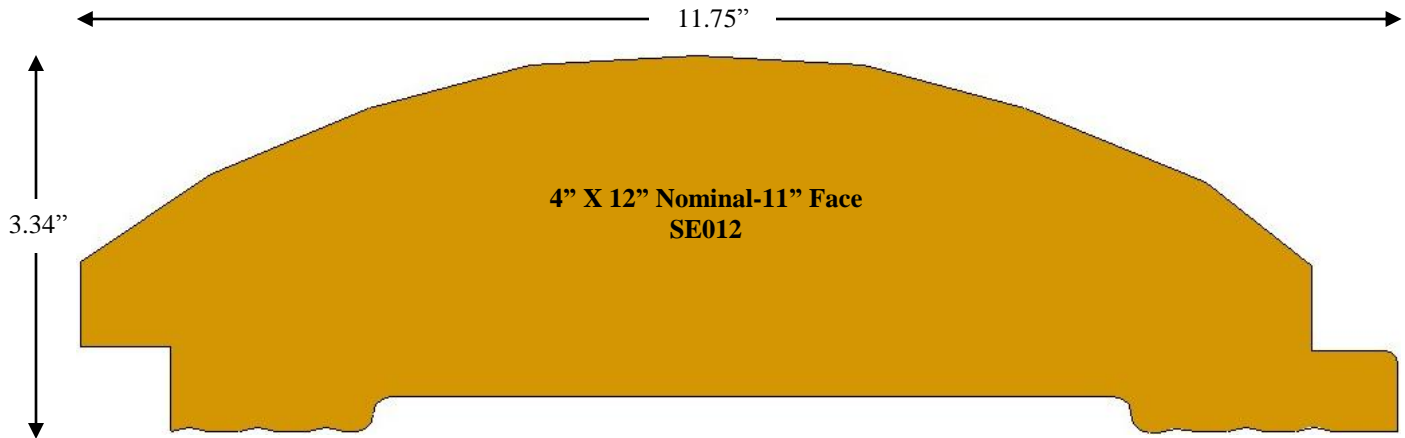

Available Specifications

Species:	White Pine, Cedar*, or Redwood*
Colors -	<u>Log & Siding</u> , <u>SRD</u> , <u>Semi-Transparent</u> , <u>Rubbol Solid</u> , Custom colors also available
Edge detail -	Shiplap
Surface -	Hewn and Sanded Face
Thickness -	4" Nominal
Widths -	12" Nominal (Click for pattern details)
Grades (specie dependent) -	Tight Knot, Select, Clear Vertical Grain
	* Non-resinous - no pitch bleed

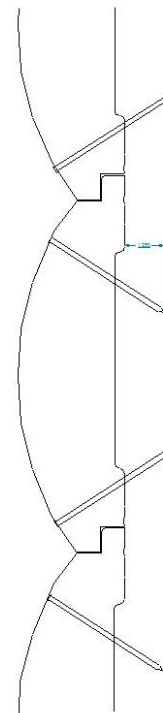

Installation Guide

Recommended $1\frac{1}{4}$ " penetration of stainless steel siding screw into wood substrate (sheeting and wall studs) behind siding. Horizontal and diagonal installation, nail into each wall stud. Vertical installation requires additional blocking every 24" between wall studs. Use 3" trim screw provided there is no foam board behind siding.

[Click to enlarge](#)

www.kwaterskibros.com

Nation's Largest Selection of Creative Wood Products